

Planting Schedule							
Tree Planting							
Code	Botanical name	Specification	Spacing (mm)	No./m ²	% MIX	Quantity	Comment
HT	Hibiscus tiliaceus	Heavy Standard	As Shown	As Shown	-	47	
Whip Mix Planting							
Mta	Macaranga tanarius	600(H)	3000	0.12	50	40	Plant each tree species in groups of 5 to 9 at random through out area designated for whip mix planting. Plant all tree in a staggered
Ceq	Casuarina equisetifolia	600(H)	3000	0.12	50	40	

NOTE:
 No. of existing tree to be fallen = 111
 No. of existing tree to be retained = 83
 No. of existing tree to be transplanted = 1

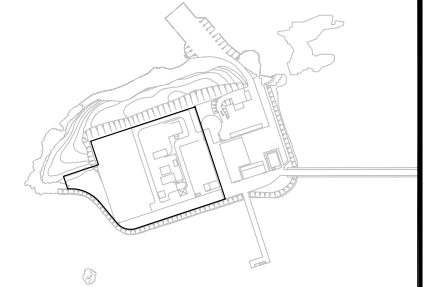

KEY PLAN

LEGEND:

- SITE BOUNDARY
- EXISTING TREE TO BE RETAINED
- PROPOSED HEAVY STANDARD SIZE TREE PLANTING
- HYDROSEEDING
- HYDROSEEDING & WHIP PLANTING
- TRANSPLANTED TREE FINAL LOCATION
- TREE SURVEY BOUNDARY
- EXTERNAL WALL/ROOF OF BUILDINGS TO BE PAINTED IN WHITE/LIGHT COLOUR TO MATCH WITH THE EXISTING BUILDINGS
- PROPOSED ROOF WITH WATER-PROOFING
- TREATMENT UNIT TO BE COVERED BY CHEQUER PLATE
- TREATMENT UNIT TO BE COVERED BY GRATING

5 0 5 Meter

 Scale 1 : 500 for A3-size

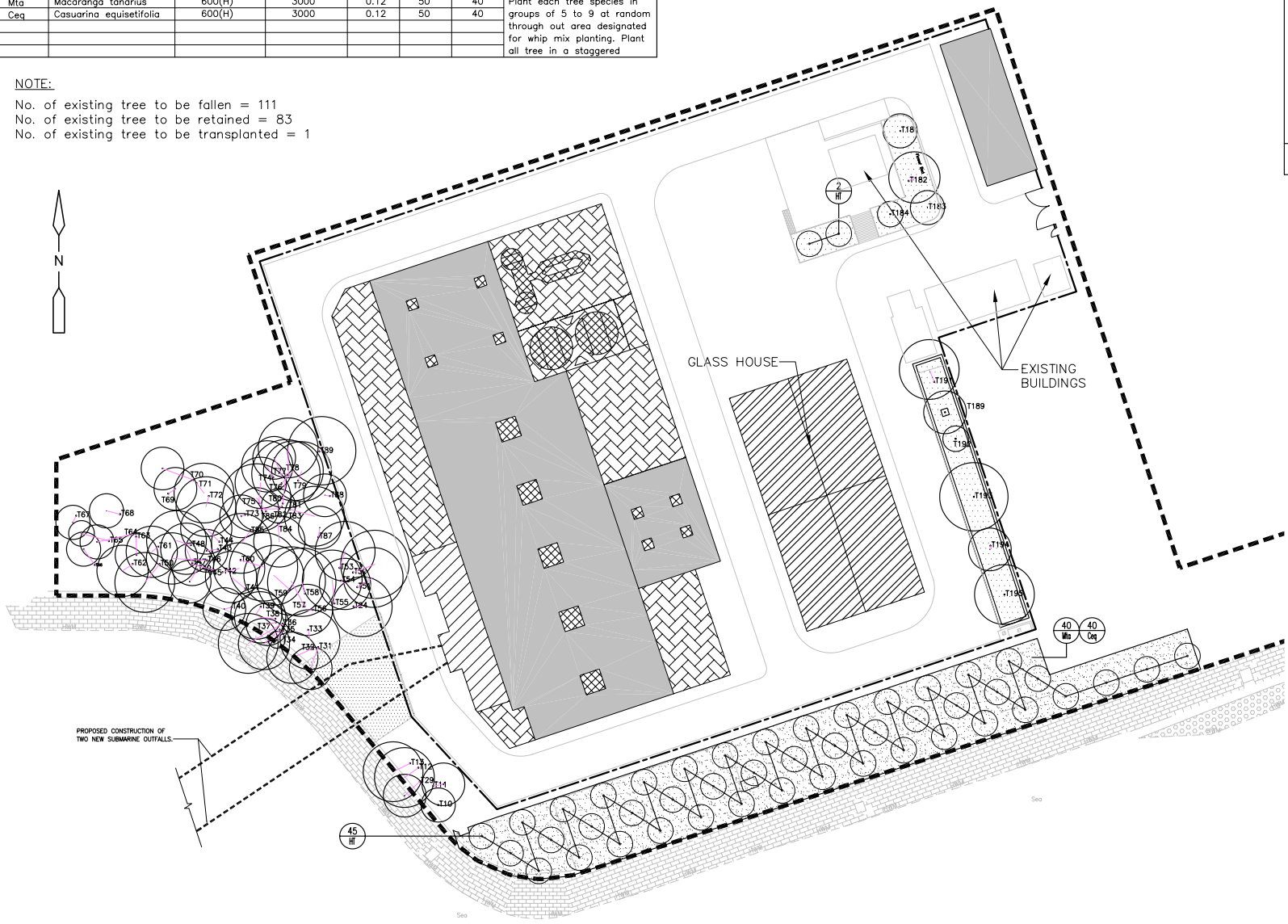

Figure 2-4d
Landscape Design Proposal
and External Finishes of Peng Chau STW Upgrade